

# King6fab DIY Rear Cross Member Mount Assembly

Step 1. Weld Nuts Here

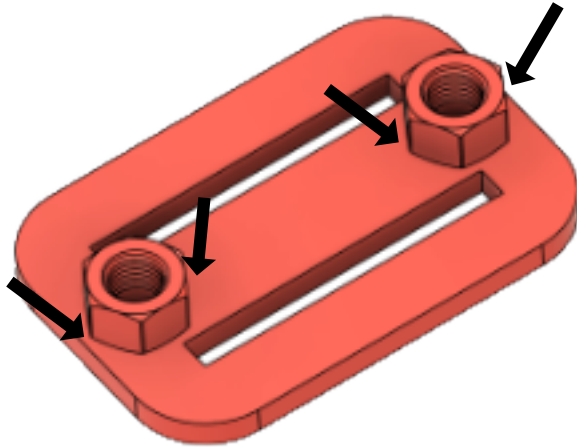

Step 2. Assemble Mount sides in slots

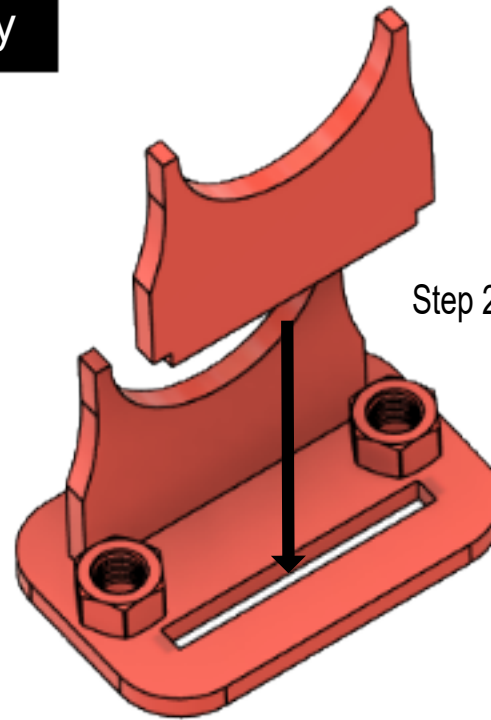

Step 3. Tack Weld sides in slots

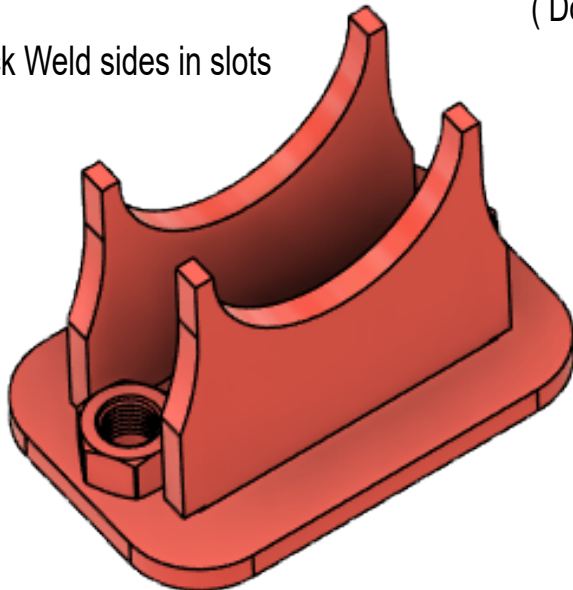

Step 4. Place tube in center of sides  
and tack weld all parts.  
( Do Not put poly bushing inside the tube when welding )  
After tack welded, finish weld all parts

